



TECTUL

REDUCCIÓN COPA - CLASE 150

MATERIALES

CARACTERÍSTICAS FÍSICAS

CARACTERÍSTICAS DIMENSIONALES

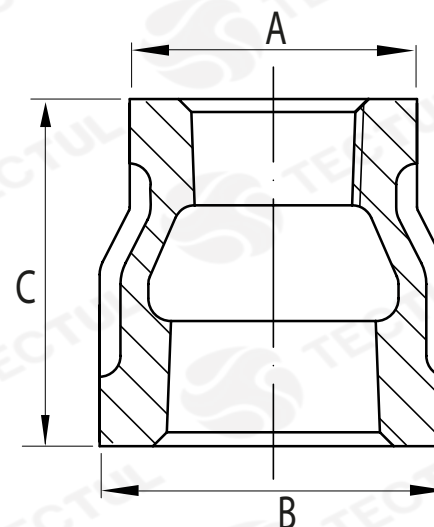

* Vista de sección transversal de tipo informativa. No representa una versión específica del accesorio o elemento.



DATOS TÉCNICOS

MEDIDA	DIAMETRO EXTERIOR 1 [mm] (A)	DIAMETRO EXTERIOR 2 [mm] (B)	ALTURA [mm] (C)	PESO [g]	MEDIDA	DIAMETRO EXTERIOR 1 [mm] (A)	DIAMETRO EXTERIOR 2 [mm] (B)	ALTURA [mm] (C)	PESO [g]
3/8" x 1/4"	22,45*	26,75*	28,70*	47*	2" x 1-1/4"	54,50*	75,00*	71,40*	517*
1/2" x 1/4"	22,45*	32,20*	31,80*	65*	2" x 1-1/2"	62,30*	75,00*	71,40*	560*
1/2" x 3/8"	26,75*	32,20*	34,00*	79*	2-1/2" x 1/2"	32,20*	93,70*	82,60*	750*
3/4" x 1/2"	30,50*	37,10*	36,60*	111*	2-1/2" x 1"	46,00*	93,70*	82,60*	753*
3/4" x 3/8"	26,75*	37,10*	36,60*	98*	2-1/2" x 1-1/4"	54,70*	93,70*	82,60*	754*
1" x 1/2"	30,50*	46,00*	42,90*	163*	2-1/2" x 1-1/2"	62,00*	93,70*	82,60*	882*
1" x 3/8"	26,75*	46,00*	42,90*	138*	2-1/2" x 2"	75,00*	93,70*	82,60*	1027*
1" x 3/4"	37,80*	46,00*	42,90*	178*	3" x 1"	46,00*	109,70*	93,70*	1174*
1-1/4" x 1/2"	30,50*	54,70*	52,30*	224*	3" x 1-1/2"	62,00*	109,70*	93,70*	1301*
1-1/4" x 3/4"	36,15*	54,70*	52,30*	200*	3" x 2"	75,00*	109,70*	93,70*	1263*
1-1/4" x 1"	46,00*	54,70*	52,30*	276*	3" x 2-1/2"	93,70*	109,70*	93,70*	1570*
1-1/2" x 1/2"	31,00*	62,00*	59,50*	284*	4" x 1-1/2"	62,00*	139,40*	111,30*	2051*
1-1/2" x 3/4"	37,80*	62,00*	59,50*	301*	4" x 1"	46,00*	139,40*	111,30*	2167*
1-1/2" x 1"	46,00*	62,00*	59,50*	342*	4" x 2"	75,00*	139,40*	111,30*	2167*
1-1/2" x 1-1/4"	56,00*	62,00*	57,00*	377*	4" x 2-1/2"	93,70*	139,40*	111,30*	2311*
2" x 1/2"	31,45*	75,00*	71,40*	430*	4" x 3"	109,70*	139,40*	111,30*	2477*
2" x 3/4"	41,00*	75,00*	71,40*	489*	6" x 3"	109,70*	199,50*	115,30*	5412*
2" x 1"	46,00*	76,00*	71,40*	490*	6" x 4"	139,40*	199,50*	115,30*	5453*

* Fotos y medidas referenciales, sujetas a cambios sin previo aviso por parte del proveedor o fabricante.

MATERIALES

Fabricado en hierro maleable negro
Recubierto ASTM A-197
ASTM A153 HOT-DIP (Caliente)

CARACTERÍSTICAS FÍSICAS

Cumple con los estándares de diseño
ANSI/ASME B16.3 y B16.14.
Extremos reforzados y estándar UL/FM

CARACTERÍSTICAS DIMENSIONALES

Dimensiones básicas según la Norma
Nacional estadounidense. Con conexión
roscada NPT según ANSI/ASME B1.20.1



TECTUL

REDUCING CUP - CLASS 150

MATERIALS



PHYSICAL CHARACTERISTICS



DIMENSIONAL CHARACTERISTICS

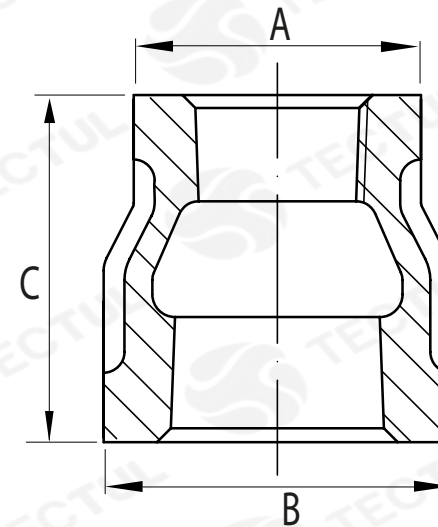

* Informational cross-sectional view. Does not represent a specific version of the accessory or item.



MATERIALS

Made of black malleable iron
ASTM A-197 coated
ASTM A153 HOT-DIP (Hot)



PHYSICAL CHARACTERISTICS

Meet design standards
ANSI/ASME B16.3 and B16.14.
UL/FM standard and reinforced ends



DIMENSIONAL CHARACTERISTICS

Basic dimensions according to the Standard
National American. With threaded
connection NPT per ANSI/ASME B1.20.1

TECHNICAL DATA

MEASURE	OUTSIDE DIAMETER 1 [mm] (A)	OUTSIDE DIAMETER 2 [mm] (B)	HEIGHT [mm] (C)	WEIGHT [g]	MEASURE	OUTSIDE DIAMETER 1 [mm] (A)	OUTSIDE DIAMETER 2 [mm] (B)	HEIGHT [mm] (C)	WEIGHT [g]
3/8" x 1/4"	22,45*	26,75*	28,70*	47*	2" x 1-1/4"	54,50*	75,00*	71,40*	517*
1/2" x 1/4"	22,45*	32,20*	31,80*	65*	2" x 1-1/2"	62,30*	75,00*	71,40*	560*
1/2" x 3/8"	26,75*	32,20*	34,00*	79*	2-1/2" x 1/2"	32,20*	93,70*	82,60*	750*
3/4" x 1/2"	30,50*	37,10*	36,60*	111*	2-1/2" x 1"	46,00*	93,70*	82,60*	753*
3/4" x 3/8"	26,75*	37,10*	36,60*	98*	2-1/2" x 1-1/4"	54,70*	93,70*	82,60*	754*
1" x 1/2"	30,50*	46,00*	42,90*	163*	2-1/2" x 1-1/2"	62,00*	93,70*	82,60*	882*
1" x 3/8"	26,75*	46,00*	42,90*	138*	2-1/2" x 2"	75,00*	93,70*	82,60*	1027*
1" x 3/4"	37,80*	46,00*	42,90*	178*	3" x 1"	46,00*	109,70*	93,70*	1174*
1-1/4" x 1/2"	30,50*	54,70*	52,30*	224*	3" x 1-1/2"	62,00*	109,70*	93,70*	1301*
1-1/4" x 3/4"	36,15*	54,70*	52,30*	200*	3" x 2"	75,00*	109,70*	93,70*	1263*
1-1/4" x 1"	46,00*	54,70*	52,30*	276*	3" x 2-1/2"	93,70*	109,70*	93,70*	1570*
1-1/2" x 1/2"	31,00*	62,00*	59,50*	284*	4" x 1-1/2"	62,00*	139,40*	111,30*	2051*
1-1/2" x 3/4"	37,80*	62,00*	59,50*	301*	4" x 1"	46,00*	139,40*	111,30*	2167*
1-1/2" x 1"	46,00*	62,00*	59,50*	342*	4" x 2"	75,00*	139,40*	111,30*	2167*
1-1/2" x 1-1/4"	56,00*	62,00*	57,00*	377*	4" x 2-1/2"	93,70*	139,40*	111,30*	2311*
2" x 1/2"	31,45*	75,00*	71,40*	430*	4" x 3"	109,70*	139,40*	111,30*	2477*
2" x 3/4"	41,00*	75,00*	71,40*	489*	6" x 3"	109,70*	199,50*	115,30*	5412*
2" x 1"	46,00*	76,00*	71,40*	490*	6" x 4"	139,40*	199,50*	115,30*	5453*

* Reference photos and measurements, subject to change without prior notice from the supplier or manufacturer.