



# TECTUL

## CODO 45° - CLASE 3000

### MATERIALES

### CARACTERÍSTICAS FÍSICAS



### CARACTERÍSTICAS DIMENSIONALES

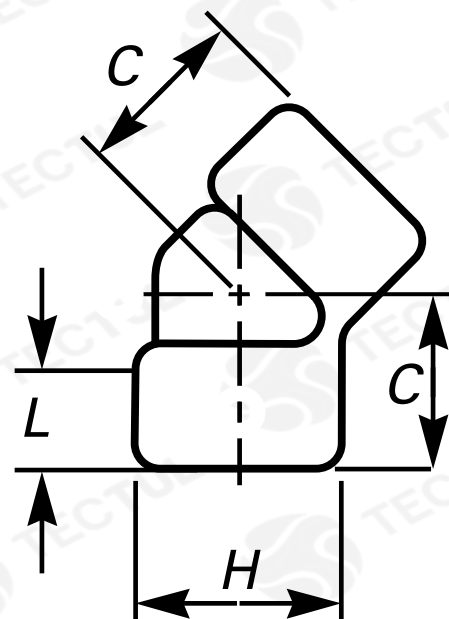

\* Vista de sección transversal de tipo informativa. No representa una versión específica del accesorio o elemento.

### MATERIALES

Fabricados en acero forjado  
ASTM A105

### CARACTERÍSTICAS FÍSICAS

Posee extremos reforzados. Ideal para la  
conduccion de gases, petróleo,  
lubricantes, vapor y aceites industriales.

### CARACTERÍSTICAS DIMENSIONALES

Dimensiones básicas según la Norma  
Nacional estadounidense. Con conexión  
roscada NPT según ANSI/ASME B1.20.1

### DATOS TÉCNICOS

MEDIDA	LONGITUD DE ROSCA [mm] (L)	DISTANCIA CENTRO [mm] (C)	ANCHO [mm] (H)	PESO [g]
1/4"	13,00*	21,00*	26,00*	116*
3/8"	10,40*	22,00*	33,00*	237*
1/2"	16,00*	25,40*	39,00*	355*
3/4"	20,00*	34,60*	46,00*	576*
1"	22,30*	40,50*	56,00*	931*
1 1/4"	23,50*	41,00*	62,00*	976*
1 1/2"	26,00*	55,00*	75,00*	2062*
2"	27,40*	56,00*	84,00*	2230*
2 1/2"	28,90*	62,00*	102,00*	4190*
3"	30,50*	76,20*	121,00*	6150*
4"	33,00*	95,10*	152,00*	11670*

\* Fotos y medidas referenciales, sujetas a cambios sin previo aviso por parte del proveedor o fabricante.



# TECTUL

## ELBOW 45° - CLASS 3000

### MATERIALS

### PHYSICAL CHARACTERISTICS

### DIMENSIONAL CHARACTERISTICS

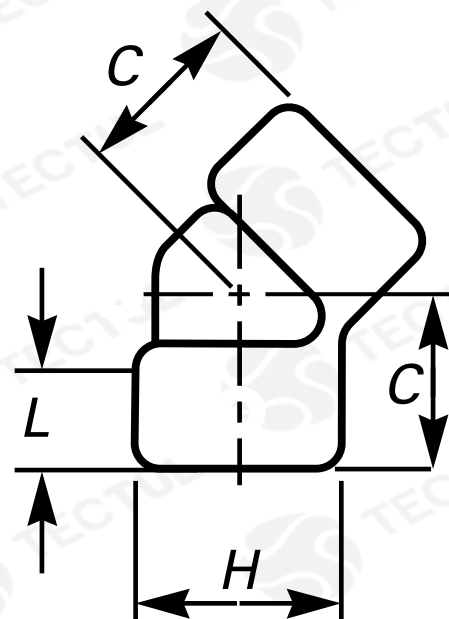

\* Informational cross-sectional view. Does not represent a specific version of the accessory or item.

**MATERIALS**

Made of forged steel  
ASTM A105

**PHYSICAL CHARACTERISTICS**

It has reinforced ends. Ideal for conduction of gases, oil, lubricants, steam and industrial oils.

**DIMENSIONAL CHARACTERISTICS**

Basic dimensions according to the Standard National American. With threaded connection NPT per ANSI/ASME B1.20.1

TECNICAL DATA				
MEASURE	THREAD LENGTH [mm] (L)	CENTER DISTANCE [mm] (C)	WIDTH [mm] (H)	WEIGHT [g]
1/4"	13,00*	21,00*	26,00*	116*
3/8"	10,40*	22,00*	33,00*	237*
1/2"	16,00*	25,40*	39,00*	355*
3/4"	20,00*	34,60*	46,00*	576*
1"	22,30*	40,50*	56,00*	931*
1 1/4"	23,50*	41,00*	62,00*	976*
1 1/2"	26,00*	55,00*	75,00*	2062*
2"	27,40*	56,00*	84,00*	2230*
2 1/2"	28,90*	62,00*	102,00*	4190*
3"	30,50*	76,20*	121,00*	6150*
4"	33,00*	95,10*	152,00*	11670*

\* Reference photos and measurements, subject to change without prior notice from the supplier or manufacturer.