



TECTUL

REDUCCIÓN COPA - CLASE 150

MATERIALES

CARACTERÍSTICAS FÍSICAS



CARACTERÍSTICAS DIMENSIONALES

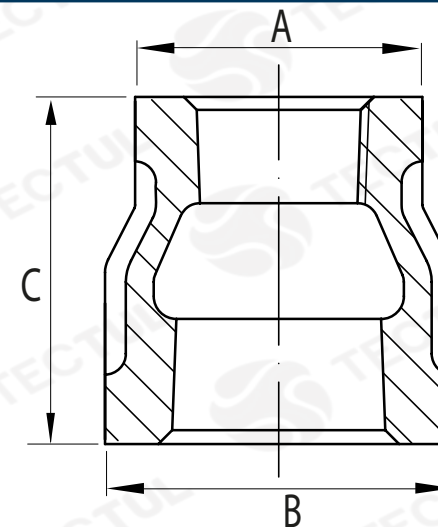

* Vista de sección transversal de tipo informativa. No representa una versión específica del accesorio o elemento.

DATOS TÉCNICOS

MEDIDA	DIAMETRO EXTERIOR 1 [mm] (A)	DIAMETRO EXTERIOR 2 [mm] (B)	ALTURA [mm] (C)	PESO [g]	MEDIDA	DIAMETRO EXTERIOR 1 [mm] (A)	DIAMETRO EXTERIOR 2 [mm] (B)	ALTURA [mm] (C)	PESO [g]
3/8" X 1/4"	23,00*	27,00*	30,00*	53*	2" x 1-1/4"	56,00*	77,00*	72,00*	542*
1/2" x 1/4"	23,00*	32,00*	34,00*	69*	2" x 1-1/2"	63,00*	77,00*	73,00*	568*
1/2" x 3/8"	27,00*	32,00*	34,00*	76*	2-1/2" x 1/2"	43,00*	94,00*	83,00*	750*
3/4" x 1/2"	30,00*	37,00*	40,00*	95*	2-1/2" x 1"	46,00*	94,00*	87,00*	875*
3/4" x 3/8"	26,00*	29,00*	38,00*	106*	2-1/2" x 1-1/4"	54,00*	90,00*	68,00*	755*
1" x 1/2"	31,00*	43,00*	46,00*	137*	2-1/2" x 1-1/2"	77,00*	94,00*	45,00*	1032*
1" x 3/8"	27,00*	46,00*	45,00*	160*	2-1/2" x 2"	72,00*	94,00*	84,00*	1167*
1" x 3/4"	37,00*	44,00*	46,00*	145*	3" x 1"	46,00*	111,00*	100,00*	1167*
1-1/4" x 1/2"	30,00*	54,00*	50,00*	182*	3" x 1-1/2"	61,00*	105,00*	74,00*	797*
1-1/4" x 3/4"	38,00*	56,00*	54,00*	252*	3" x 2"	76,00*	110,00*	95,00*	1296*
1-1/4" x 1"	43,00*	53,00*	50,00*	202*	3" x 2-1/2"	93,00*	110,00*	96,00*	1574*
1-1/2" x 1/2"	29,00*	60,00*	57,00*	229*	4" x 1-1/2"	63,00*	139,00*	116,00*	2041*
1-1/2" x 3/4"	37,00*	60,00*	55,00*	237*	4" x 1"	46,00*	140,00*	117,00*	2200*
1-1/2" x 1"	44,00*	60,00*	54,00*	257*	4" x 2"	76,00*	141,00*	117,00*	2029*
1-1/2" x 1-1/4"	53,00*	60,00*	54,00*	289*	4" x 2-1/2"	93,00*	140,00*	115,00*	2360*
2" x 1/2"	32,00*	78,00*	76,00*	511*	4" x 3"	111,00*	139,00*	115,00*	2400*
2" x 3/4"	38,00*	77,00*	76,00*	448	6" x 3"	111,00*	195,00*	108,00*	5412*
2" x 1"	47,00*	77,00*	74,00*	498*	6" x 4"	138,00*	195,00*	108,00*	4459*

* Fotos y medidas referenciales, sujetas a cambios sin previo aviso por parte del proveedor o fabricante.

MATERIALES



Fabricado en hierro maleable galvanizado. Recubierto ASTM A-197 ASTM A153 HOT-DIP (Caliente)

CARACTERÍSTICAS FÍSICAS



Cumple con los estándares de diseño ANSI/ASME B16.3 y B16.14. Extremos reforzados y estándar UL/FM

CARACTERÍSTICAS DIMENSIONALES



Dimensiones básicas según la Norma Nacional estadounidense. Con conexión roscada NPT según ANSI/ASME B1.20.1



TECTUL

REDUCING CUP - CLASS 150

MATERIALS



PHYSICAL CHARACTERISTICS



DIMENSIONAL CHARACTERISTICS

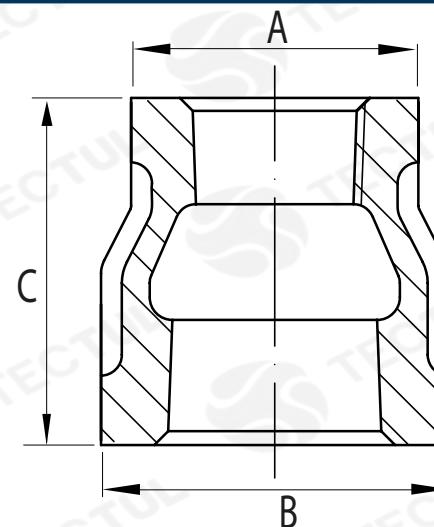

* Informational cross-sectional view. Does not represent a specific version of the accessory or item.

TECHNICAL DATA

MEASURE	OUTSIDE DIAMETER 1 [mm] (A)	OUTSIDE DIAMETER 2 [mm] (B)	HEIGHT [mm] (C)	WEIGHT [g]	MEASURE	OUTSIDE DIAMETER 1 [mm] (A)	OUTSIDE DIAMETER 2 [mm] (B)	HEIGHT [mm] (C)	WEIGHT [g]
3/8" X 1/4"	23,00*	27,00*	30,00*	53*	2" x 1-1/4"	56,00*	77,00*	72,00*	542*
1/2" x 1/4"	23,00*	32,00*	34,00*	69*	2" x 1-1/2"	63,00*	77,00*	73,00*	562*
1/2" x 3/8"	27,00*	32,00*	34,00*	76*	2-1/2" x 1/2"	43,00*	94,00*	83,00*	750*
3/4" x 1/2"	30,00*	37,00*	40,00*	95*	2-1/2" x 1"	46,00*	94,00*	87,00*	875*
3/4" x 3/8"	26,00*	29,00*	38,00*	106*	2-1/2" x 1-1/4"	54,00*	90,00*	68,00*	755*
1" x 1/2"	31,00*	43,00*	46,00*	137*	2-1/2" x 1-1/2"	77,00*	94,00*	45,00*	1032*
1" x 3/8"	27,00*	46,00*	45,00*	160*	2-1/2" x 2"	72,00*	94,00*	84,00*	1167*
1" x 3/4"	37,00*	44,00*	46,00*	145*	3" x 1"	46,00*	111,00*	100,00*	1167*
1-1/4" x 1/2"	30,00*	54,00*	50,00*	182*	3" x 1-1/2"	61,00*	105,00*	74,00*	797*
1-1/4" x 3/4"	38,00*	56,00*	54,00*	252*	3" x 2"	76,00*	110,00*	95,00*	1296*
1-1/4" x 1"	43,00*	53,00*	50,00*	202*	3" x 2-1/2"	93,00*	110,00*	96,00*	1574*
1-1/2" x 1/2"	29,00*	60,00*	57,00*	229*	4" x 1-1/2"	63,00*	139,00*	116,00*	2041*
1-1/2" x 3/4"	37,00*	60,00*	55,00*	237*	4" x 1"	46,00*	140,00*	117,00*	2200*
1-1/2" x 1"	44,00*	60,00*	54,00*	257*	4" x 2"	76,00*	141,00*	117,00*	2029*
1-1/2" x 1-1/4"	53,00*	60,00*	54,00*	289*	4" x 2-1/2"	93,00*	140,00*	115,00*	2360*
2" x 1/2"	32,00*	78,00*	76,00*	511*	4" x 3"	111,00*	139,00*	115,00*	2400*
2" x 3/4"	38,00*	77,00*	76,00*	448*	6" x 3"	111,00*	195,00*	108,00*	5412*
2" x 1"	47,00*	77,00*	74,00*	498*	6" x 4"	138,00*	195,00*	108,00*	4459*

* Reference photos and measurements, subject to change without prior notice from the supplier or manufacturer.

MATERIALS



Made of galvanized malleable iron
Coated ASTM A-197
ASTM A153 HOT-DIP (Hot)

PHYSICAL CHARACTERISTICS



Meets design standards
ANSI/ASME B16.3 and B16.14.
Reinforced ends and UL/FM standard

DIMENSIONAL CHARACTERISTICS



Basic dimensions according to the Standard
National American. With threaded
connection NPT per ANSI/ASME B1.20.1